

MARINE FENDERS

Docks • Piers • Piles • Bridge Abutments



A Division of Maritime International, Inc.





For more than 50 years, Schuyler Companies have been a leader in the marine fender business. We design and manufacture rubber bumpers specifically crafted for the most abusive marine environments, like those of barge docking facilities.

Irregular barge hulls and unpredictable berthing methods inflict severe wear and tear on traditional wood timbers, resulting in high maintenance costs and short life spans. Schuyler Companies' rubber bumpers provide an affordable, low maintenance, long-lasting alternative to wood timbers.

Schuyler Companies' laminated rubber bumpers are manufactured to stand up to the most adverse conditions in the world. They are recognized as the most rugged and durable fenders available. Our fenders have been subjected to laboratory performance and abrasion tests (see last section of catalog) for proven field durability. They can be mounted to steel beams, sheet piles, wood or concrete structures by bolted or welded installation means.

No other type dock protection can match the durability and maintenance free performance of these bumpers.



Schuyler Companies' laminated rubber bumpers are manufactured from 100% recycled tire material. We've taken materials that would otherwise be land filled, and turned them into the most durable, long lasting fenders available in the market today. Environmentally conscious companies know that our fenders are the only 'green' alternative to traditional wood timber bumpers, and molded rubber fenders; both of which consume precious natural resources. Do your part to help the world 'go green', use Schuyler Companies' laminated bumpers for your dock or pier.



A Division of Maritime International, Inc.



Steel Beam Fenders - Model 115

Our Model 115 fenders offer installation flexibility for your steel structure. There are several configurations to suit any beam size and/or type, whether welded or bolted are required.

	A	B	C
in	6 to 22	6 to 240	6 to 120
mm	152.4 to 558.8	152.4 to 6096	152.4 to 3048

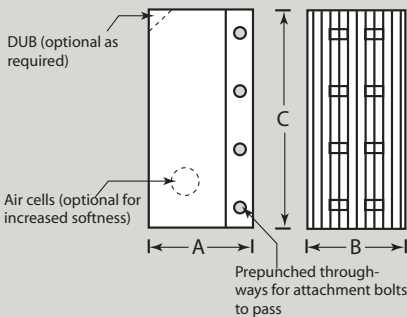

Solid type laminated rubber fenders are perfect for dock applications that do not require energy absorption but rather a rugged, abrasion resistant surface. These fenders are very well suited for barge dock operations where a durable, long lasting rubbing surface is needed.

- Model 115 Fenders are manufactured and designed for quick and reliable installation in the field.
- Various attachment configurations available - bolt or weld on.
- Unlike molded rubber or wood timbers, tough plies of reinforced rubber eliminate chipping.
- Size and softness (solid or SR3D-2) varies to satisfy particular design requirements.
- Vertical or horizontal mounting.

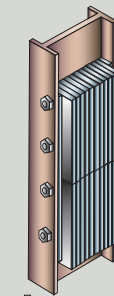

**Type A
Weldless**

- Countersink style with prepunched through-ways
- Fender is positioned into I-beam with attachment bolts passing through I-beam or channel and prepunched through-ways in fender

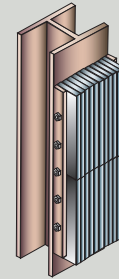
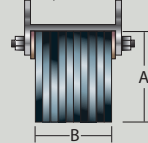

**Type B
Standard**

- Securing flatbar welded directly to steel fascia

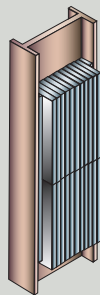
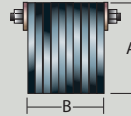

**Type C
Countersink**

- Through rods are countersunk and welded into flatbar rather than nutted
- Fender is welded into existing channel

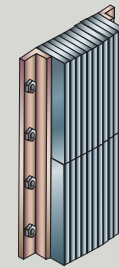
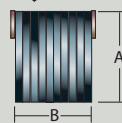

**Type D
Angle**

- Securing angle welded to steel fascia or bolted into concrete fascia

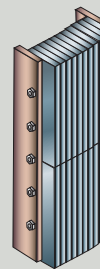
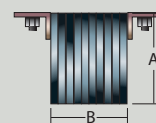

**Type E
Extended**

- Securing flatbar extends over steel or concrete box structure for welding or bolting

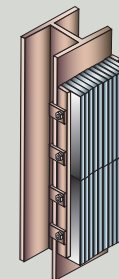
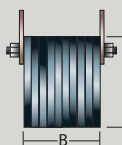

**Type F
Clamp**

- Steel clamps secure fender to backside of I-beam

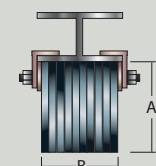



Sheet Pile & Concrete Dock Fenders - Model 114

Our Model 114 fenders offer installation flexibility for your sheet pile dock. There are several configurations to suit any sheet pile style and size with welded or bolted connections.



Plan View

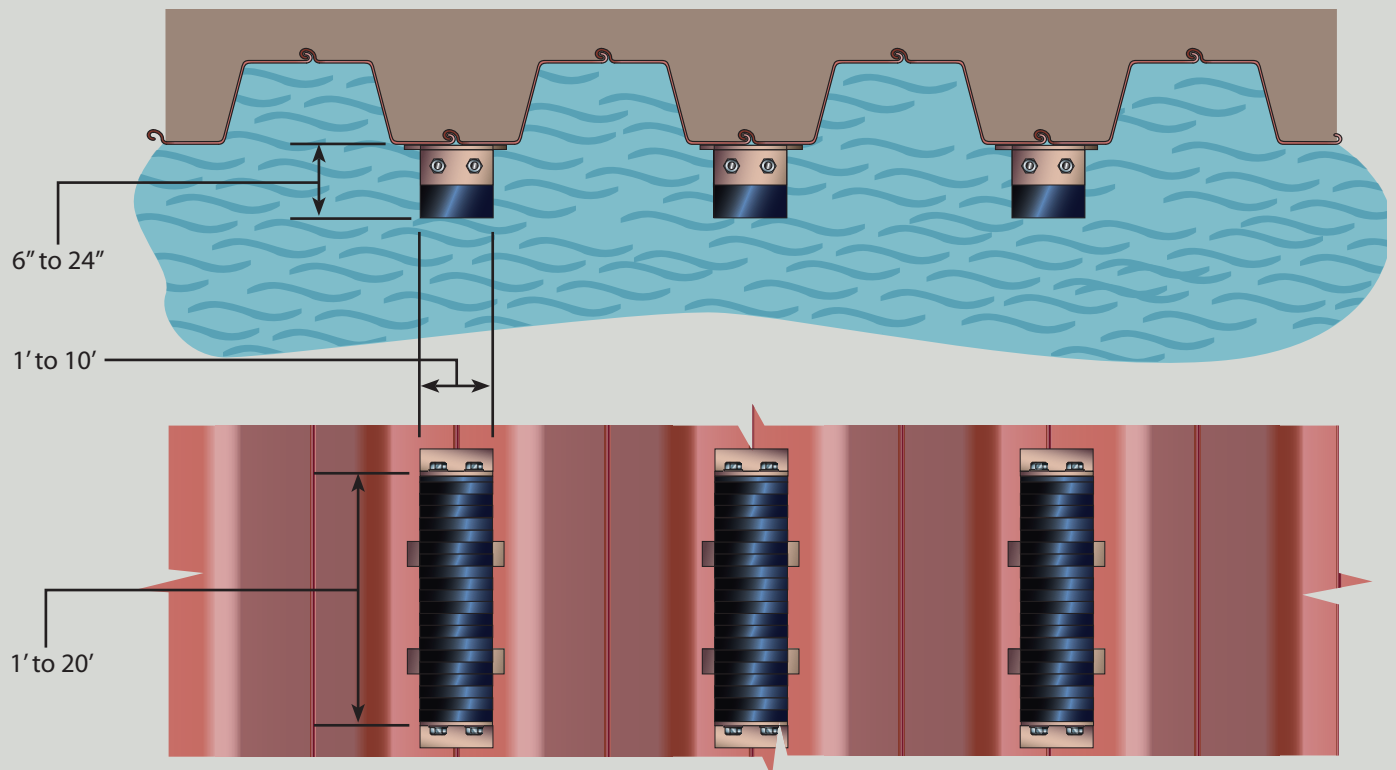

Elevation View

Pile Fenders - Model 153

Pile fenders provide an effective way to protect steel or concrete piles from barge traffic. They are pre-curved to suit the required diameter pile and degree of coverage needed. These pile wrap fenders can be welded, bolted, or clamped to a pile depending on the project requirements.

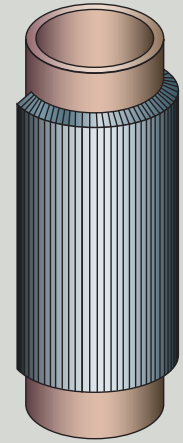

Note: Degree of coverage on pile, thickness of rubber and SR3D-2 soft loop vs. solid rubber configuration as required.

Our Model 153 pile wrap fenders are a recycled product manufactured from heavy duty rubber material. This material and manufacturing process forms the most robust, durable fender in the world.

- Model 153 Fenders are manufactured in pre-curved units ready to install. Fenders can be hung prior to pile driving to save field time.
- The Model 153 can either be welded, bolted, or clamped to steel dolphin piles, or bolted or clamped to concrete piles.
- The size and softness (solid or SR3D-2) varies to satisfy particular design requirements.
- Area of coverage depends upon batter and number of piles in cluster.
- Applications include, but are not limited to: ferry landings, barge mooring dolphins, bridge foundations and landing dolphins.

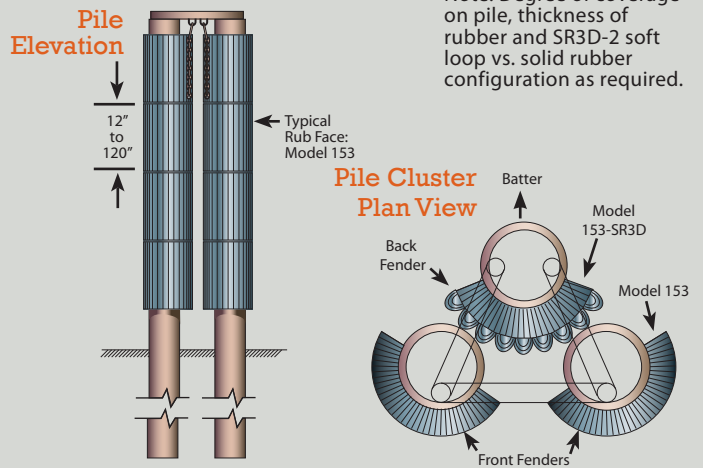

Pipe Pile Fender Mounting Details

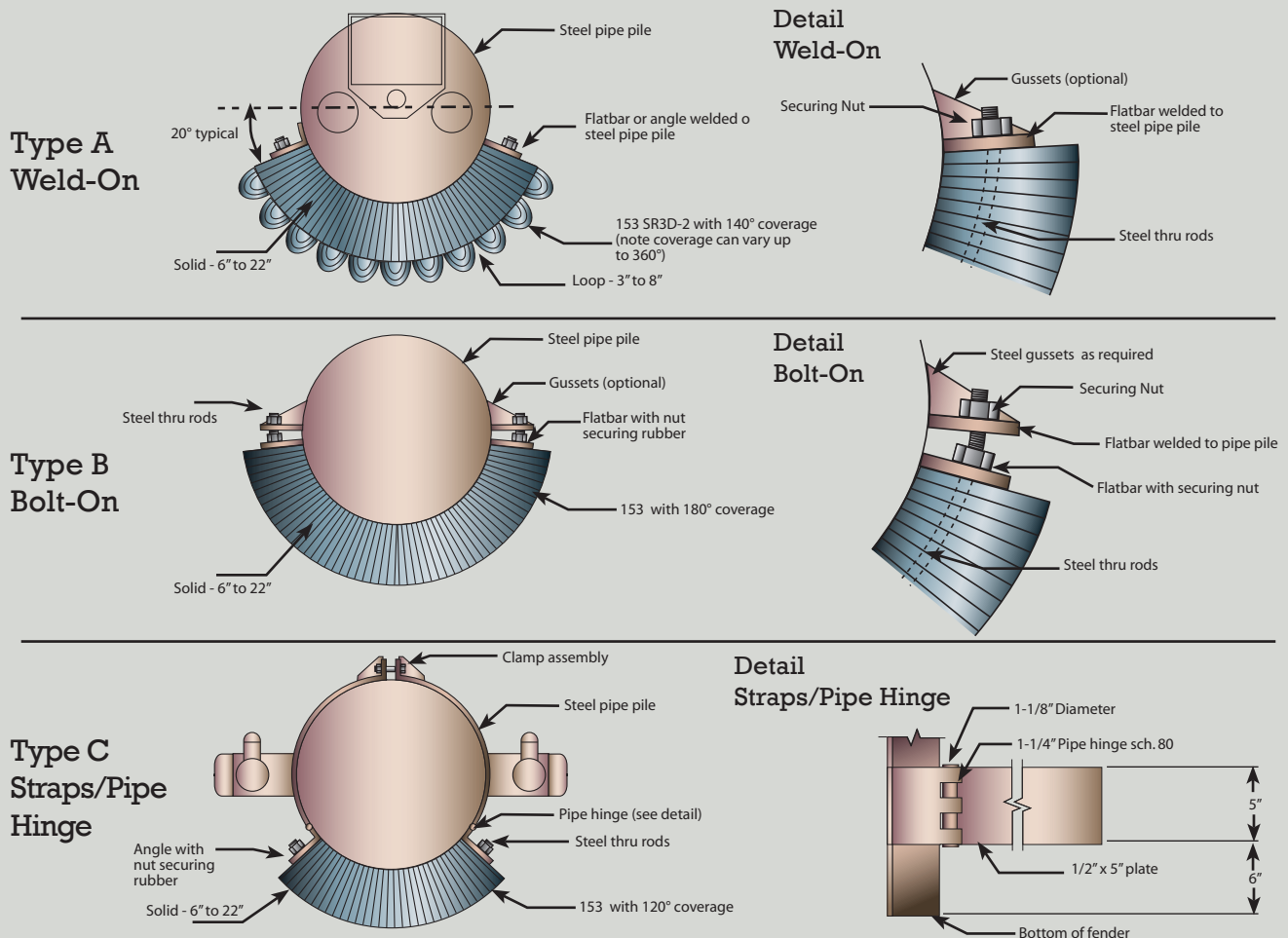

Test Data (Abrasion & Performance)

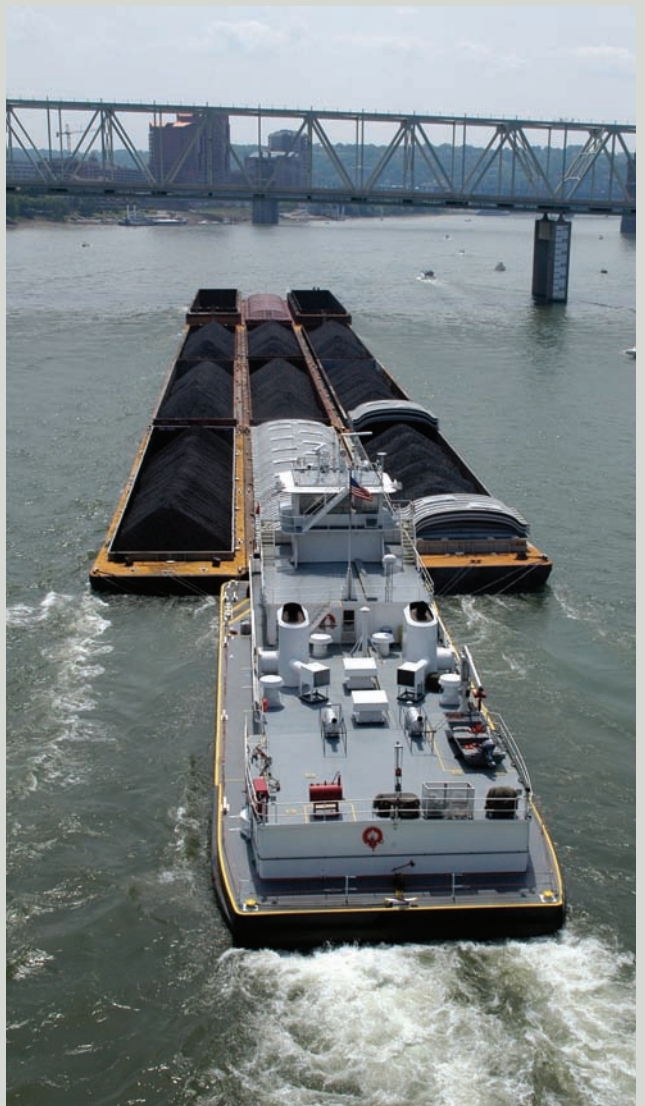

Abrasion Resistance Test

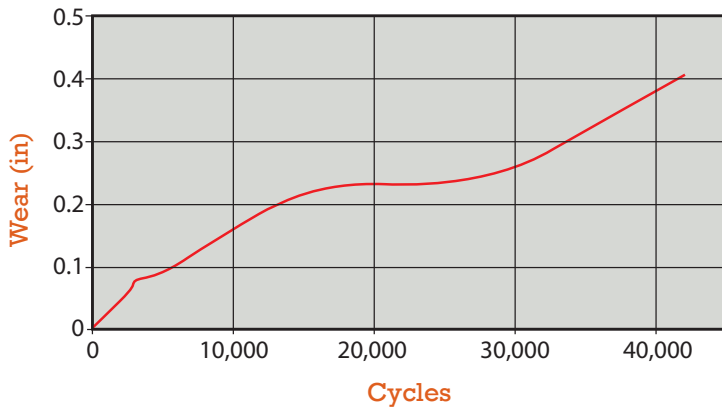

Fender Performance (per square foot)

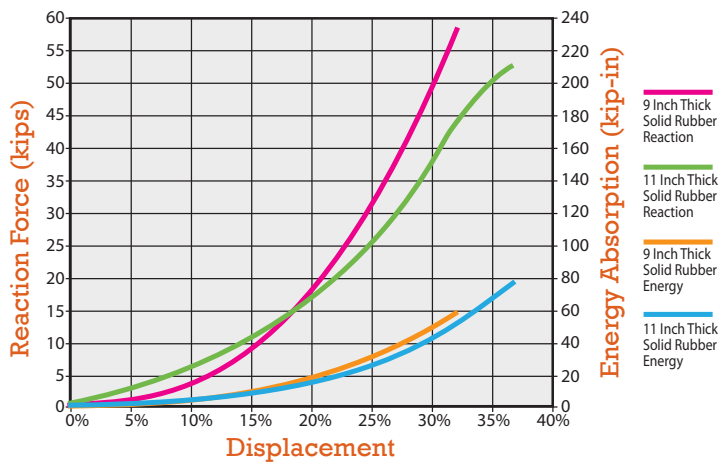

A Division of Maritime International, Inc.

SCHUYLER COMPANIES

Broussard, LA - PH 866-347-9445 • FX 337-769-4799

Seattle, WA - PH 800-426-3917 • FX 425-488-2424

website: www.dock-fenders.com

email: sales@schuylermaritime.com